



FAG

**6009-2Z**

Deep groove ball bearing

Schaeffler ID:  
0167176350000Deep groove ball bearing 60...-2Z, single  
row, shields, steel sheet metal cage

## Technical information

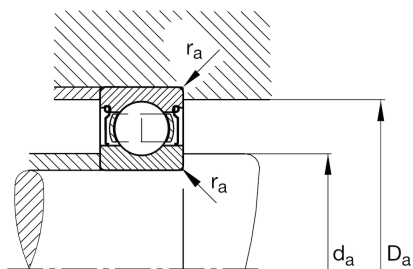
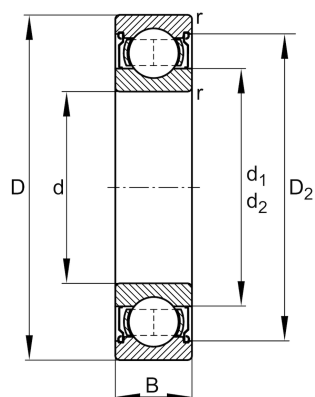
**Main Dimensions & Performance Data**

d	45 mm	Bore diameter
D	75 mm	Outside diameter
B	16 mm	Width
$C_r$	21.200 N	Basic dynamic load rating, radial
$C_{0r}$	14.400 N	Basic static load rating, radial
$C_{ur}$	750 N	Fatigue load limit, radial
$n_G$	11.200 1/min	Limiting speed
$n_{gr}$	9.700 1/min	Reference speed
	0,241 kg	Weight

**Dimensions**

$r_{min}$	1 mm	Minimum chamfer dimension
$D_2$	68 mm	Caliber diameter outer ring
$d_1$	54,2 mm	Shoulder diameter inner ring

**Mounting dimensions**

$d_{a min}$	49,6 mm	Minimum diameter shaft shoulder
$D_{a max}$	70,4 mm	Maximum diameter of housing shoulder
$r_{a max}$	1 mm	Maximum fillet radius

**Calculation factors**

$f_0$	15,3	Calculation factor
-------	------	--------------------

**Temperature range**

$T_{min}$	-20 °C	Operating temperature min.
$T_{max}$	120 °C	Operating temperature max.